

大容量型冷凍離心機 Refrigerated Type (High Capacity)

4

離心機系列 Centrifuge Series



CN-650R



CN-650RD



特點：

- 採用無刷馬達。
- LCD數位面板，具溫度、轉速及離心力雙重切換、設定及顯示功能。
- 10組記憶系統，可預先設定常用參數。
- 不平衡斷電、過載、故障指示安全防護裝置。
- 具預冷功能。

Feature :

- Brushless Motor
- LCD digital panel with temperature, RPM & RCF switch, setting and display functions
- 10 memory programs for presetting parameters
- With auto power-off safety devices included rotor imbalance, overload, and error indication
- With the pre-cooling function

Model	CN-650R	CN-650RD
轉速 Speed (rpm)	500~6,000	
最大離心力 Max. RCF (xg)	5,760	
最大容量 Max. Capacity (ml)	1,000	
溫度範圍 Temperature range	0°C ~ 40°C	
定時器 Timer (min:sec)	99:59	
重量 Weight (kg)	112	75
尺寸 Size (W x L x H mm)	520 x 650 x 900	800 x 600 x 380
電源 Power	AC 220V, 50/60Hz	

◎ 離心試管另購。 Tubes not included.

Rotor sets for CN-650R, CN-650RD



RS-9602



RS-2504

Rotor	Capacity (ml x pcs)	Tube Size (Ø x L) mm	Max. Speed (rpm)	Max. RCF (xg)
RS-9602	96 well plate x 4	126 ~ 129 x 83 ~ 86	2,500	1,180
RS-2504	250ml x 4	61 ~ 65.5 x 90 ~ 127	3,500	2,320



RA-1512H-1



RA-5008

Rotor	Capacity (ml x pcs)	Tube Size (Ø x L) mm	Max. Speed (rpm)	Max. RCF (xg)
RA-1512H-1	15ml x 12	15~17.3 x 92~122	6,000	4,270
RA-5008	50ml x 8	27.5~29.5 x 84~116	6,000	4,270



RS-50



15ml x 8pcs



15ml x 16pcs

50ml x 4pcs
(plastic)50ml x 4pcs
(glass)

100ml x 4pcs

Rotor	Capacity (ml x pcs)	Tube Size (Ø x L) mm	Max. Speed (rpm)	Max. RCF (xg)
RS-50	15ml x 8	15~17.3 x 90~115	4,500	3,270
	15ml x 16	15~17.3 x 90~110	4,500	3,270
	50ml x 4 (plastic)	26.5~29.5 x 90~120	5,500	4,840
	50ml x 4 (glass)	32~35 x 90~112	4,000	2,490
	100ml x 4	42~45 x 97~112	5,000	4,030



RS-55A



15ml x 8pcs



15ml x 16pcs

50ml x 4pcs
(plastic)50ml x 4pcs
(glass)

100ml x 4pcs

Rotor	Capacity (ml x pcs)	Tube Size (Ø x L) mm	Max. Speed (rpm)	Max. RCF (xg)
RS-55A	15ml x 8	15~17.3 x 90~115	5,000	4,030
	15ml x 16	15~17.3 x 90~120	5,000	4,030
	50ml x 4 (plastic)	26.5~29.5 x 90~120	6,000	5,760
	50ml x 4 (glass)	32~35 x 90~112	5,000	3,890
	100ml x 4	42~45 x 97~112	5,000	4,030

■ Rotor sets for CN-650R, CN-650RD



RS-100



6ml x 56pcs



10ml x 48pcs



15ml x 16pcs



15ml x 32pcs

50ml x 4pcs
(plastic)50ml x 4pcs
(glass)50ml x 8pcs
(plastic)50ml x 8pcs
(glass)

100ml x 4pcs

Rotor	Capacity (ml x pcs)	Tube Size (Ø x L) mm	Max. Speed (rpm)	Max. RCF (xg)
RS-100	6ml x 56	10~12.5 x 50~105	3,500	2,160
	10ml x 48	13~15.5 x 50~107	3,500	2,160
	15ml x 16	15~17.3 x 92~130	3,500	2,290
	15ml x 32	15~17.3 x 90~116	3,500	2,290
	50ml x 4 (plastic)	26.5~29.5 x 90~137	5,000	4,640
	50ml x 4 (glass)	32~35 x 86~133	4,000	2,880
	50ml x 8 (plastic)	26.5~29.5 x 90~127	3,500	2,280
	50ml x 8 (glass)	32~35 x 86~120	3,500	2,210
	100ml x 4	42~45 x 96~130	4,000	2,970



RS-250

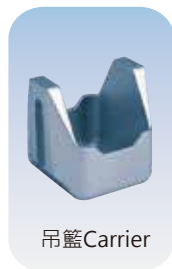

吊籃Carrier

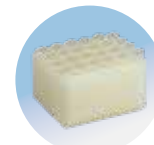

1.5ml x 96pcs



6ml x 112pcs

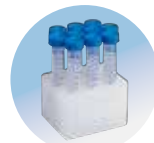

10ml x 80pcs

15ml x 40pcs
(plastic)

15ml x 48pcs

50ml x 16pcs
(plastic)

250ml x 4pcs

Rotor	Capacity (ml x pcs)	Tube Size (Ø x L) mm	Max. Speed (rpm)	Max. RCF (xg)
RS-250	1.5ml x 96	8~10.5 x 41~90	3,500	2,360
	6ml x 112	9.5~11.5 x 60~110		
	10ml x 80	13.5~15.5 x 60~105		
	15ml x 40 (plastic)	14~16 x 60~120		
	15ml x 48	15~17 x 60~117		
	50ml x 16 (plastic)	27.5~29.5 x 60~117		
	250ml x 4	58~61.5 x 66~127		